

# CEILING GRID LAYOUT

## Efficiently Design & Co-ordinate Ceiling Layouts

**Ceiling Grid Layout** gives the user the ability to create complex ceiling layouts and reflective plans with the aid of an intuitive user interface, allowing multiple 3D ceiling plan development in the same timeframe as manual 2D creation.

The intuitive UI allows users to scale underlays, create complex layouts consisting of 90 degree, arcs and curves, all with minimal effort.

**Ceiling Grid Layout** utilises MAP's integrated database of content, proving accurate BIM-rich data of costs, weights, area volumes etc. for estimating, co-ordination, service verification/validation and manufacture.

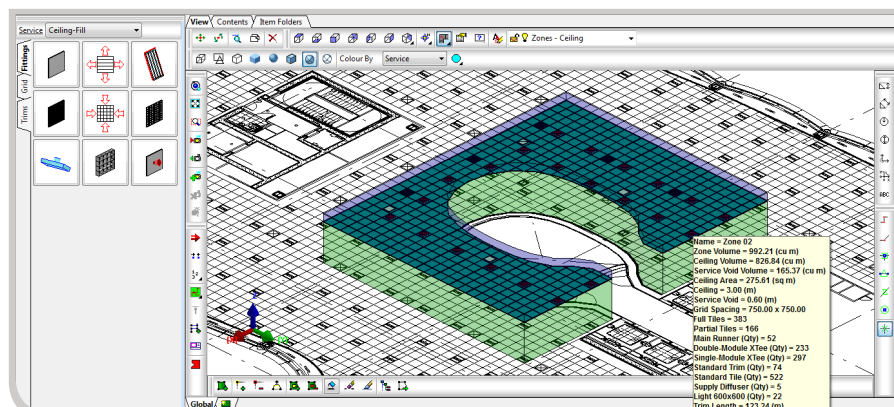

Use CAD MEP+ to design advanced and co-ordinated building service models then apply 'layout points'

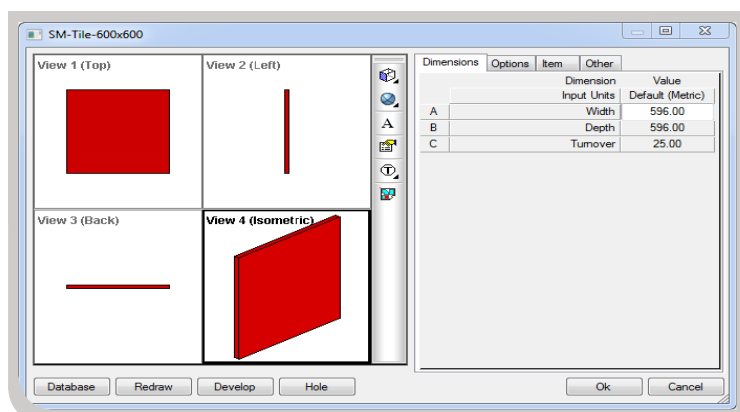

Use CAD MEP+ to design advanced and co-ordinated building service models then apply 'layout points'

Using the wide range of pre-configured equipment to suit the Ceiling Layout industry, users can tender, design and co-ordinate straight away. The integrated content has been specifically designed to incorporate industry standards and specifications.

**Ceiling Grid Layout** even allows users to import 3<sup>rd</sup> party underlays, which can then be designed and co-ordinated with fully comprehensive reflective ceiling models and investigated in a detailed 3D environment.

Overall, the **Ceiling Grid Layout** solution provided by MAP Software will increase productivity and speed of turnaround, creating detailed 3D models based on industry standards that are rich in BIM data.

The solution helps you make efficient modifications and time-saving revisions which reduce errors throughout the life span of the contract from tender to as-built on-site.

Digital collaboration means each user in the design process can access every detail of the project from tender to as-built

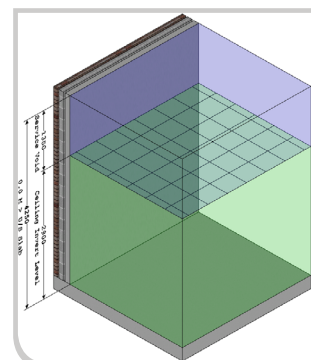
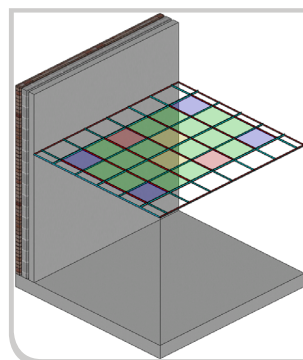

## How about some more information?

If you want to see **Ceiling Grid Layout** in action, or talk to someone directly about the benefits the solution can provide for you, call us now on **+44 (0)1253 792 112** or email us on **info@map-software.com**